

Facsimile

Quick Reference Guide

Model No. **KX-PW601DL**
KX-PW601DW



KX-PW601DL

Thank you for purchasing a Panasonic facsimile.

Table of Contents





Finding the controls	2
Installations and connections	4
Setting the date and time	7
Setting your facsimile telephone number	7
Setting your logo	8
Character input and command key table	9
Automatic dialing on the main unit.....	10
Automatic dialing on the portable handset	12
Intercom between the main unit and portable handset	14
Sending faxes	15
Receiving faxes	16
Operating the built-in answering device	18
Individual e-mail services	19
Specifications.....	Back cover

- This guide explains some basic features and operations, but not all of them. For further details, see the Japanese operating instructions.
- This product is designed for use in Japan. Panasonic cannot provide service for this product if used outside Japan.
- Any details given in this guide are subject to change without notice.

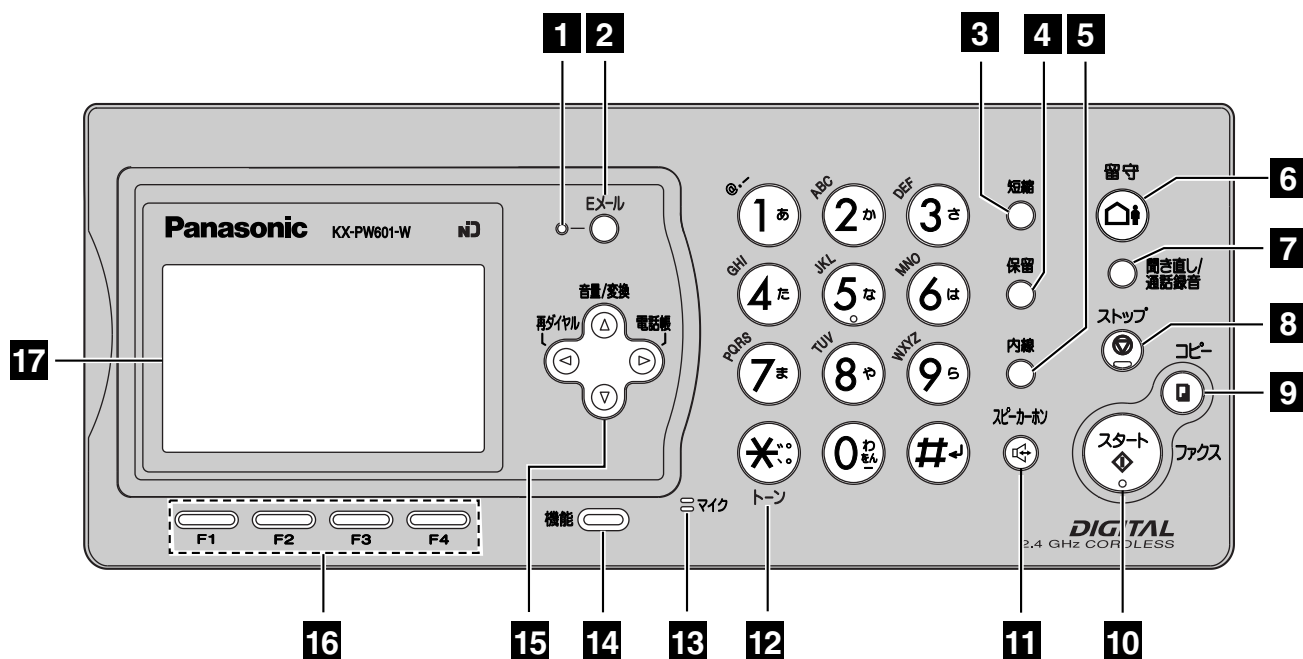
Finding the controls

Main unit (control panel)



- 1 E-Mail indicator**
- 2 E-Mail button**
Pause button
- 3 Speed Dialer button**
- 4 Hold button**
- 5 Intercom button**
- 6 Auto Answer button & indicator**
—light on: answering device activated.
—light off: used as a regular telephone.
- 7 Replay button** plays back recorded messages.
Record button records telephone calls.
- 8 Stop button**
- 9 Copy button** starts copying.
Mute button
- 10 Start/Fax button** starts faxing.
- 11 Speakerphone button & indicator**
- 12 Tone button** switches to tone dialing.
- 13 Microphone**
- 14 Function button** initiates programming.
- 15 Volume/Redial/Phonebook/Addressbook key**
 -  To adjust the volume.
 -  To change Hiragana into Kanji.
 -  To redial the phone numbers in the redial list. The last 10 phone numbers dialed are stored in memory.
 -  To use the phonebook and the addressbook.
- 16 Multi-operation buttons** refer to the function displayed on the display panel.
- 17 Liquid crystal display**

Finding the controls

Portable handset

How to use key

電話帳 To use the phonebook.

再ダイヤル To redial the phone numbers in the redial list. The last 10 phone numbers dialed are stored in memory.

音量/変換 To adjust the volume.
To change Hiragana into Kanji.

外線 To make/answer calls.

内線 To page the main unit or another portable handset.
クリアー To clear letters/numbers.

切 To end a call.
To end or exit from editing or other operations.

保留 To put a call on hold.
着信メモリー To start a search in the Number Display log. (For caller ID display service users.)

To adjust the receiver tone quality.

キャッチ For call waiting service users.

ワンタッチ To use the one-touch dial.

スピーカーホン To use the speakerphone.

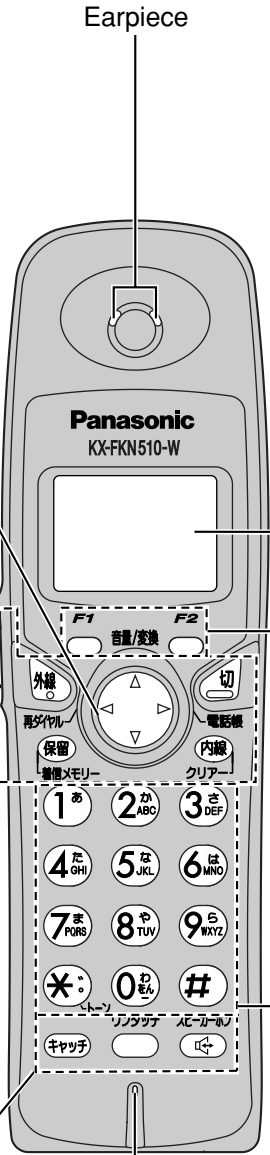

Microphone
(Do not cover the microphone while talking.)

LCD (with back light)

Displays battery strength, telephone numbers etc.

The LCD display shows several indicators: 1. Portable handset number (子機1), 2. Directional arrows (音量/変換 key can be tilted), 3. Out of range (圏外), 4. Battery strength indicator, and 5. Function menu (機能/留守).

① Portable handset number
② Indicates which directions the **音量/変換** key can be tilted.
 up and down
 left
③ Out of range (Walk closer to the main unit.)
④ Battery strength
⑤ Function menu that is controlled by **F1** or **F2**.

How to use **F1 **F2** buttons**

F1 and **F2** buttons refer to the function displayed on the bottom of the display. They function differently depending on the mode.

Dial buttons

トーン Tone button
To switch to Tone dialing mode.

Sharp button

Note:

If you use the portable handset near a microwave oven which is being used, noise may be heard from the earpiece or the speaker. Move away from the microwave oven and closer to the main unit.

Installations and connections

Installing the ink film

- 1** Open the control panel and the back cover.

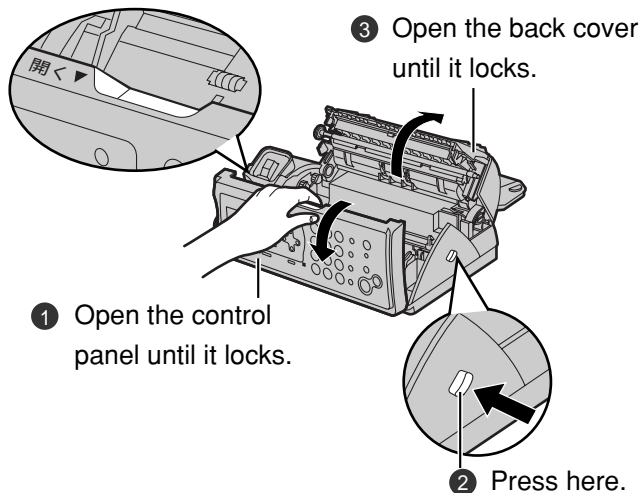

- 2** Insert the ink film.

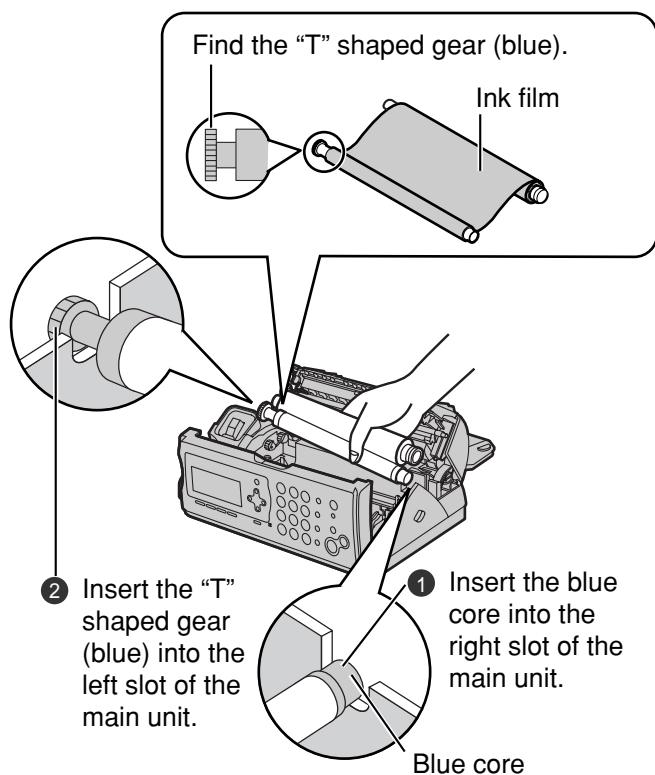

- 3** If the ink film is slack, tighten it by winding the "T" shaped gear.

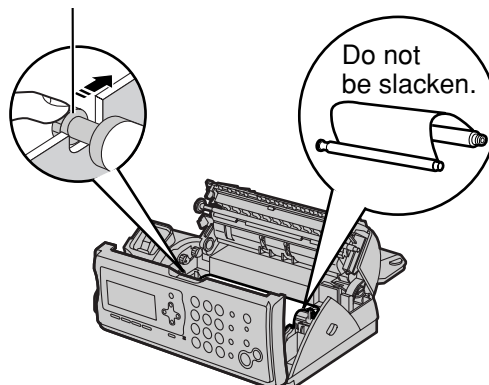

- 4** Close the back cover and the control panel until they lock.

- ① To close the back cover, press here.

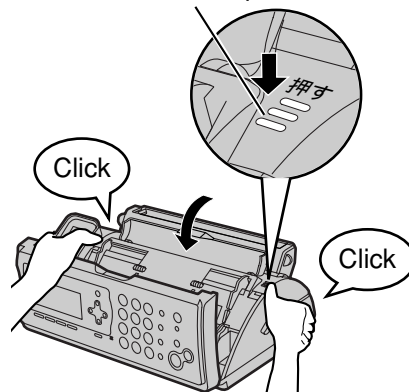

- ② Close the control panel until it locks.

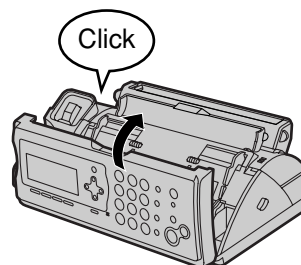

- When the unit runs out of ink film, the following message will be displayed.

フィルムがなくなりましたU23
交換してください

フィルムがなくなりましたU23
品番 : KX-FAN142

Install a new ink film.

Replacement ink film:
KX-FAN142 (35 m) ¥1250

· As of June 2003. · Tax not included.

Installations and connections

Installing recording paper (A4 size)

1 Install the recording paper tray.

- 1 Separate the recording paper cover from the recording paper tray.

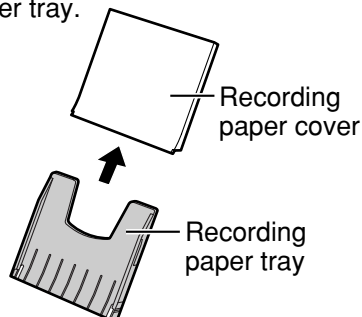

- 2 Insert the left tab on the recording paper tray into the left slot of the main unit.
- 3 Insert the right tab into the right slot of the main unit.

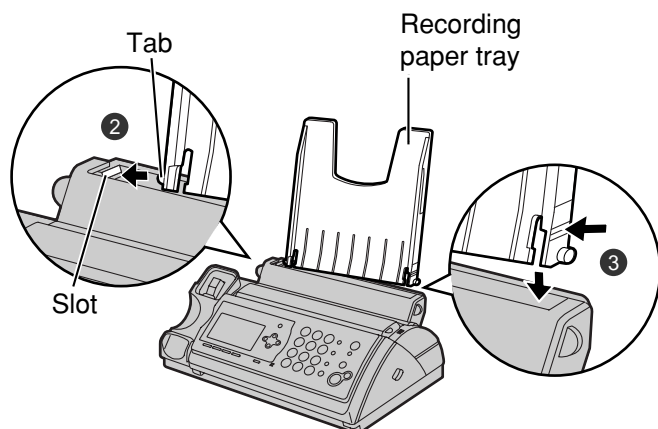

2 Insert the recording paper into the recording paper tray.

- 1 Open the paper entrance cover until it locks.

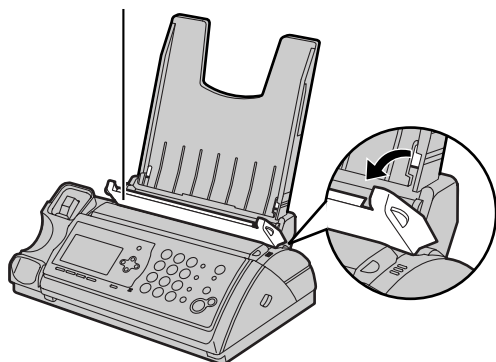

- 2 Fan the stack of recording paper (A4 size).

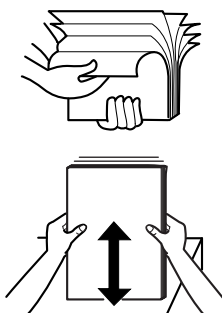

- 3 Insert the recording paper into the recording paper tray. (Up to 30 sheets)

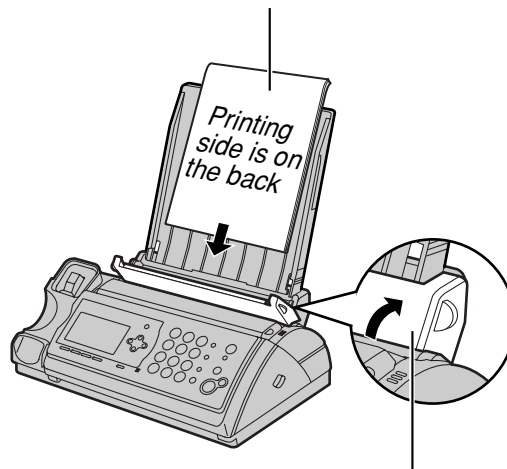

- 4 Close the paper entrance cover by leaning it back.

3 Install the recording paper cover on the recording paper tray by sliding it down from the top.

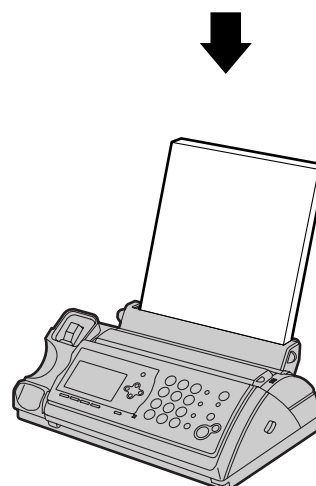
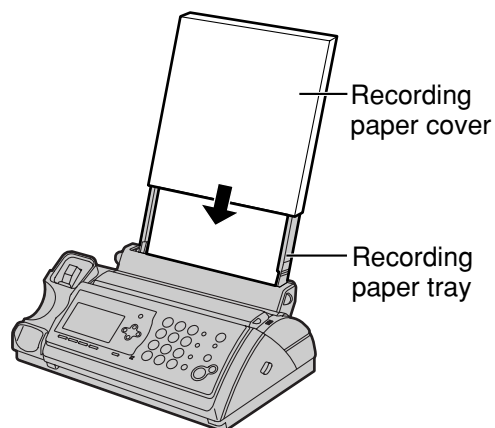

Installations and connections

Connecting the main unit

- 1 Connect the cord and place the handset on the main unit.

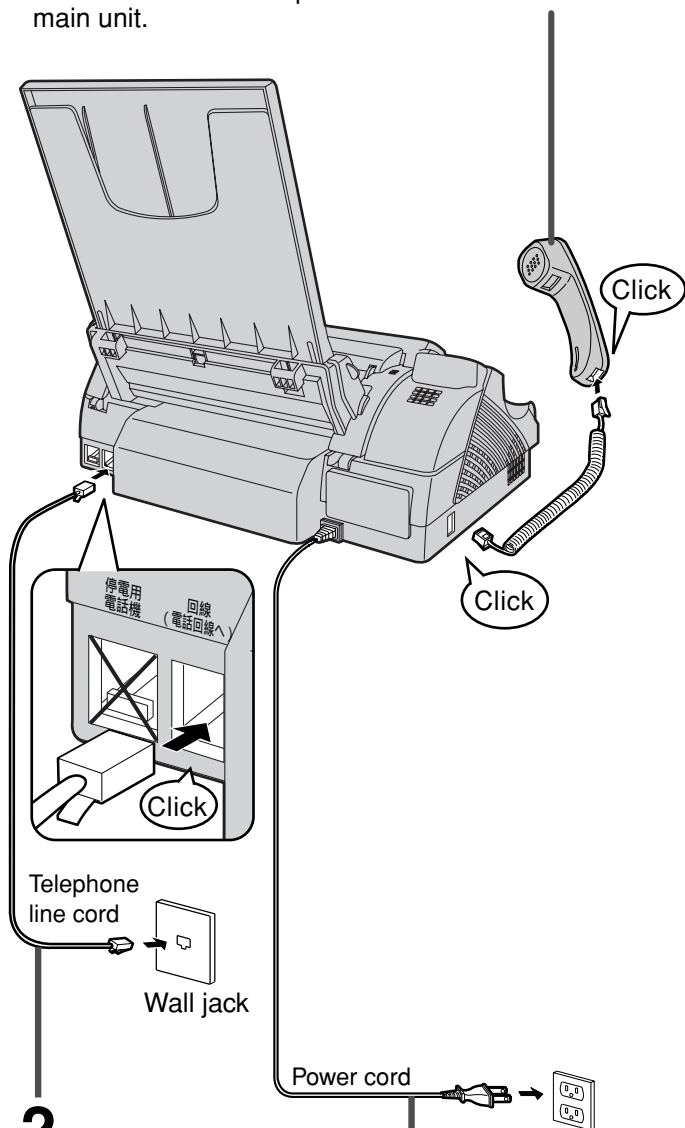

- 2 Connect the telephone line cord (Supplied accessory).

- 3 Connect the power cord.

After the Power On...

This unit will automatically select the dialing mode (Tone/Pulse).

Setting up the portable handset

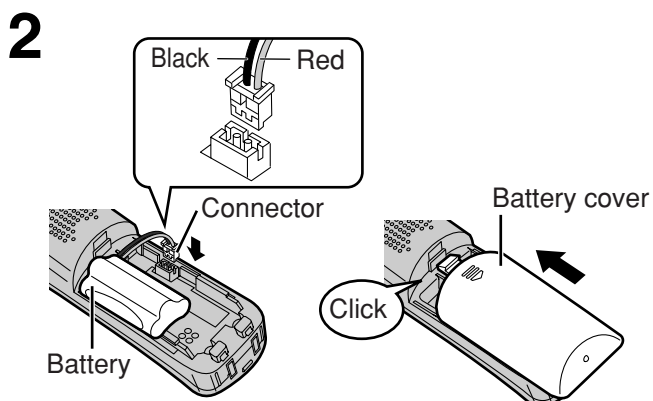
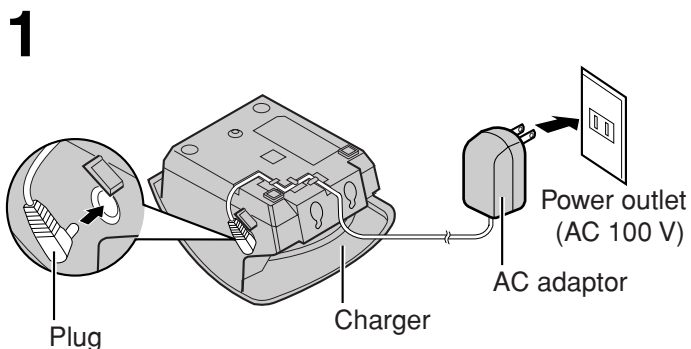

- 3 Charge the battery in the charger for 10 hours.

- After your Panasonic battery is fully charged, it will last up to about 7 hours of conversation.

- While charging.

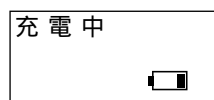

- Charging completed.

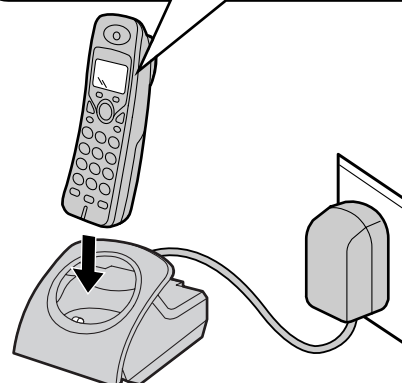
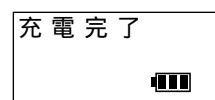

Setting the date and time

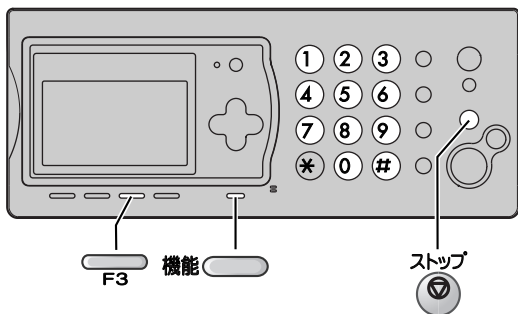

1 Press 機能 (Function).

機能登録モード

2 Press # 0 0 1 .

Example : 2003年 06月 01日
20:10
Cursor

3 Enter the correct year/month/day.

Example: October 1, 2003

Press 2 0 0 3 1 0 0 1 .

2003年 10月 01日
20:10

4 Enter the correct hour/minute in a 24-hour clock entry.

Example: 15:45 (3:45 PM)

Press 1 5 4 5 .

2003年 10月 01日
15:45

5 Press 決定/登録 (Set/Register).

登録しました



2003年 10月 01日
15:45

6 Press ストップ (Stop).

Example : 10月 1日 15:45
用件録音 00件

Setting your facsimile telephone number

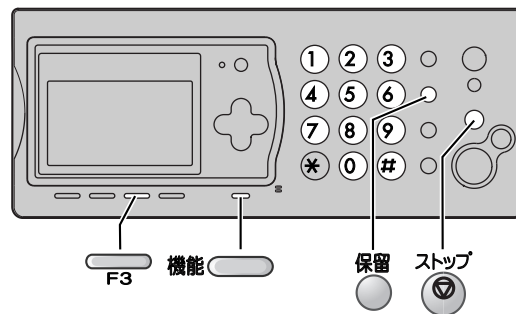

1 Press 機能 (Function).

機能登録モード

2 Press # 0 0 4 .

あなたの電話番号?
.....
Cursor

3 Enter your facsimile telephone number, up to 20 digits.

Example: 098 765 43 ..

あなたの電話番号?
098 765 43

保留
The (Space) button replaces the digit with a space.

4 Press 決定/登録 (Set/Register).

登録しました



あなたの電話番号?
098 765 43

5 Press ストップ (Stop).

Example : 10月 1日 15:45
用件録音 00件

Setting your logo

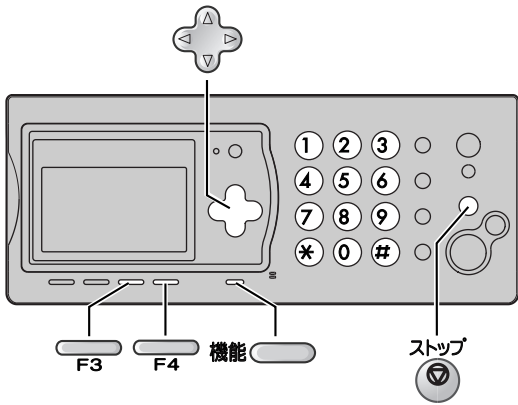

1 Press 機能 (Function).

機能登録モード

2 Press # 0 0 2 .

名前 (印刷用)?
>

Cursor

3 Enter your logo, up to 30 characters, using the dial keypad.

- To enter English characters easily, press ^{文字切替}F4 (Character input mode) repeatedly and select “英” (English and sign input mode).
- For details, see the table on page 9 for instructions.

Example: Micah

1. Press 6 once.

M
Cursor

2. Press 4 six times.

Mi

3. Press 2 six times.

Mic

4. Press to move the cursor to the next space and press 2 four times.

Mic a

5. Press 4 five times.

Micah

4 Press ^{決定/登録}F3 (Set/Register).

登録しました



Micah
>

5 Press ^{ストップ} (Stop).

Example :

10月 1日 15:45
用件録音 00件

Character input and command key table

Pressing the dial keys will select a character as shown below.

Character		“かな” Hiragana	“カナ” Katakana	“英” English	“数” Numbers
Dial key					
(Main unit) ①	(Portable handset) ①	あいうえおあいうえお	アイウエオアイウエオ	@ . _ - & \$ ¥ % + = ~ ^	1
②	②	かきくけこ	カキクケコ	A B C a b c	2
③	③	さしすせそ	サシスセソ	D E F d e f	3
④	④	たちつてとっ	タチツテトツ	G H I g h i	4
⑤	⑤	なにぬねの	ナニヌネノ	J K L j k l	5
⑥	⑥	はひふへほ	ハヒフヘホ	M N O m n o	6
⑦	⑦	まみむめも	マミムメモ	P Q R S p q r s	7
⑧	⑧	やゆよやゆよ	ヤユヨヤユヨ	T U V t u v	8
⑨	⑨	らりるれろ	ラリルレロ	W X Y Z w x y z	9
⑩	⑩	わをんー！？()	ワヲンー！？()	! ? / - * # , ; : . ' ” () [] { } 「 」	0
✳	✳	” ° 、 。		、 。	
Command keys		文字切替 F4 (Main unit), F2 (Portable handset)		Used to change the character input mode.	
		← (Main unit), → (Portable handset)		Used to move the cursor to the left and right.	
		クリアー F1 (Main unit), 内線 (Portable handset)		Used to delete a character.	
		保留 ● (Main unit), ● (Portable handset)		Used to insert a space.	

- When entering e-mail address, the small letters are displayed before the capital letters.
- When entering e-mail address, you can not enter the following symbols: ` ` ° - ` ` 「 」
- When entering e-mail address, you can enter only English and Numbers.
- When entering e-mail message, pressing (✳) enables you to begin the new line. (“↵” is displayed.)
- The display items of the main unit are somewhat different from those of the portable handset.

Automatic dialing on the main unit

Storing names and telephone numbers in the phonebook

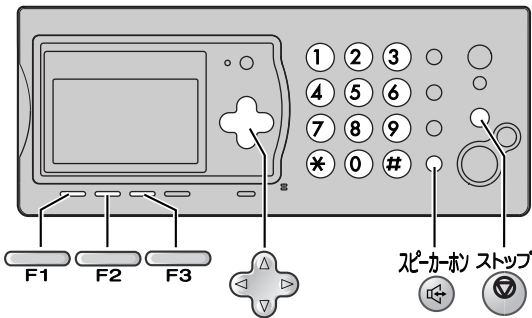

1 Press  (Phonebook).

検索は[▼▲]を押す

2 Press  (Set/Register).

- “XXX” shows the remaining station numbers you can store.
- You can program up to 150 stations, including 4 pre-programmed stations.

電話帳空き x x x 件

3 Enter the name, up to 20 characters (see the table on page 9 for instructions).

4 Press  (Set/Register) twice.

5 Enter the telephone number, up to 24 digits.

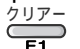
- To correct a mistake, press  (Clear).

6 Press  (Set/Register).

7 If necessary, enter the group number (1-9).

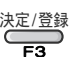
8 Press  (Set/Register).

- To program other items, repeat steps 3 to 8.

9 Press  (Stop) to exit the program.

Making a voice call using the phonebook

1 Press  (Phonebook).

2 Press  (Search button) repeatedly until the desired name is displayed.

3 Lift the handset or press  (Speakerphone).

Editing a stored name or number in the phonebook

1 Press  (Phonebook).

2 Press  (Search button) repeatedly until the desired name is displayed.

3 Press  (Edit).

4 Edit the name (see the table on page 9 for instructions).

- If you do not need to edit the name, skip to step 5.

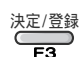
5 Press  (Set/Register).

6 Edit the kana.

- If you do not need to edit the kana, skip to step 7.

7 Press  (Set/Register).

8 Edit the telephone number.

- If you do not need to edit the telephone number, skip to step 9.

9 Press  (Set/Register).

10 If necessary, enter the correct group number.

11 Press  (Set/Register).

12 Press  (Stop) to exit the program.

Automatic dialing on the main unit

Storing names and telephone numbers in the speed dialer

You can store up to 9 names and telephone numbers which are stored in the phonebook. The dialing buttons (① to ⑨) function as memory stations.

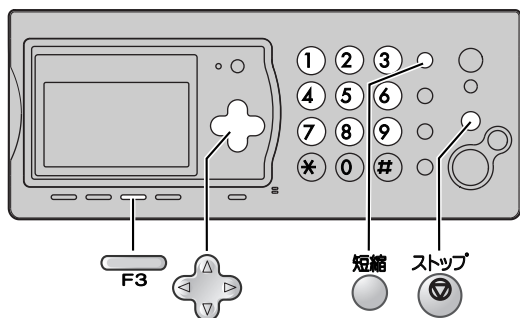

1 Press  (Speed dialer).

2 Press the memory station number (① to ⑨).
Example: speed dialer 1

1.登録されていません

Memory station number

3 Press  (Set/Register).

4 Press  (Search button) repeatedly until the desired name is displayed.

5 Press  (Set/Register).

- To program other items in other stations, repeat steps 2 to 5.

6 Press  (Stop) to exit the program.

Making a voice call using the speed dialer

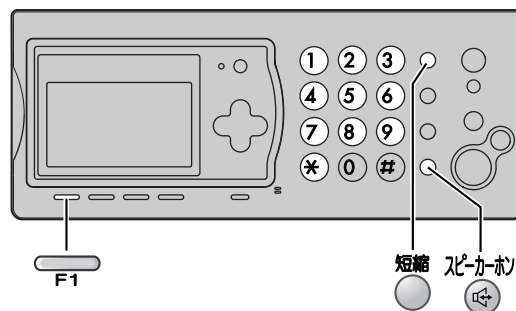

1 Press  (Speed dialer).

2 Press the memory station number (① to ⑨).

3 Lift the handset or press  (Speakerphone).

Erasing a stored name and number in the speed dialer

1 Press  (Speed dialer).

2 Press the memory station number (① to ⑨).

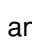
3 Press  (Erase) and  (Yes).

Automatic dialing on the portable handset

Storing telephone number in the one-touch dial

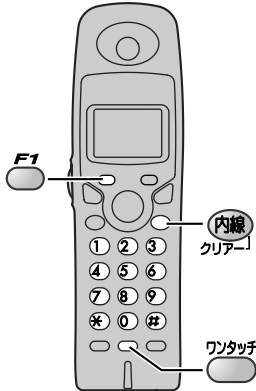

1 Press  (one-touch).

ワンタッチ
登録されて
いません

2 Enter the telephone number, up to 24 digits.

- To correct a mistake, press  (Clear).

ワンタッチ登録
09876543..

3 Press  (Register).

Making a voice call using the one-touch dial

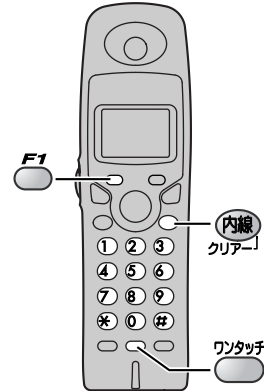

1 Press  (one-touch).

- The unit will start dialing.

2 When the other party answers, start talking.

Editing a stored number in the one-touch dial

1 Press  (Function).

2 Press  (one-touch).

3 Edit the telephone number, up to 24 digits.

4 Press  (Register).

Erasing a stored number in the one-touch dial

1 Press  (Function).

2 Press  (one-touch).

3 Press and hold  (Erase) until the telephone number has been erased.

4 Press  (Register).

Automatic dialing on the portable handset

Storing names and telephone numbers in the phonebook

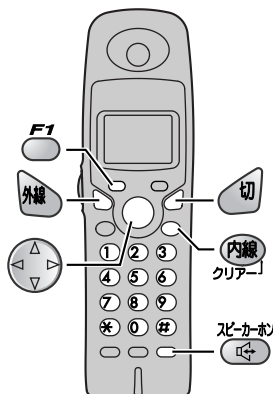

1 Press (Phonebook).

検索は
[▼▲]を押す

2 Press (Register).

- “XXX” shows the remaining station numbers you can store.
- You can program up to 150 stations, including 4 pre-programmed stations.

名前？
空き x x x 件

3 Enter the name, up to 20 characters (see the table on page 9 for instructions).

4 Press (Register) twice.

5 Enter the telephone number, up to 24 digits.

- To correct a mistake, press (Clear).

6 Press (Register).

7 If necessary, enter the group number (1-9).

8 Press (Register).

- To program other items, repeat steps 3 to 8.

9 Press (Off) to exit the program.

Making a voice call using the phonebook

1 Press (Phonebook).

2 Press (Search button) repeatedly until the desired name is displayed.

3 Press (Talk) or press (Speakerphone).

Editing a stored name or number in the phonebook

1 Press (Phonebook).

2 Press (Search button) repeatedly until the desired name is displayed.

3 Press (Edit).

4 Edit the name (see the table on page 9 for instructions).

- If you do not need to edit the name, skip to step 5.

5 Press (Register).

6 Edit the kana.

- If you do not need to edit the kana, skip to step 7.

7 Press (Register).

8 Edit the telephone number.

- If you do not need to edit the telephone number, skip to step 9.

9 Press (Register).

10 If necessary, enter the correct group number.

11 Press (Register).

12 Press (Off) to exit the program.

Intercom between the main unit and portable handset

An intercom is available between the main unit and portable handset.

A 2-way intercom is available between 2 portable handsets.

(For KX-PW601DL users: An optional handset is needed when using this feature.)

Using the main unit:

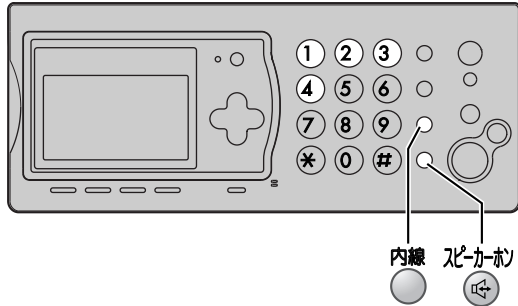

1 ■ For single portable handset users



- ① Lift the handset.

番号 ?

- ② Press  (Intercom).

子機 1呼出中

■ For multiple portable handset users

- ① Lift the handset.
- ② Press  (Intercom).
- ③ Press the portable handset number ( to ) which you want to call.

内線番号
[1 2] を押す

2 Start talking.

- You can switch to the speakerphone by pressing  (Speakerphone).

子機 1内線通話中

3 Replace the handset to end the intercom call.

Using the portable handset:

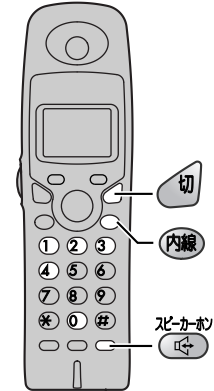



1 ■ For single portable handset users

Press  (Intercom).

■ For multiple portable handset users

Press  (Intercom), then press .

Intercom between portable handsets:

Press  (Intercom), then press the portable handset number ( to ) which you want to call.

2 Start talking.

- You can switch to the speakerphone by pressing  (Speakerphone).

内線通話中

3 Press (Off) to end the intercom call.

Sending faxes

Sending a fax manually

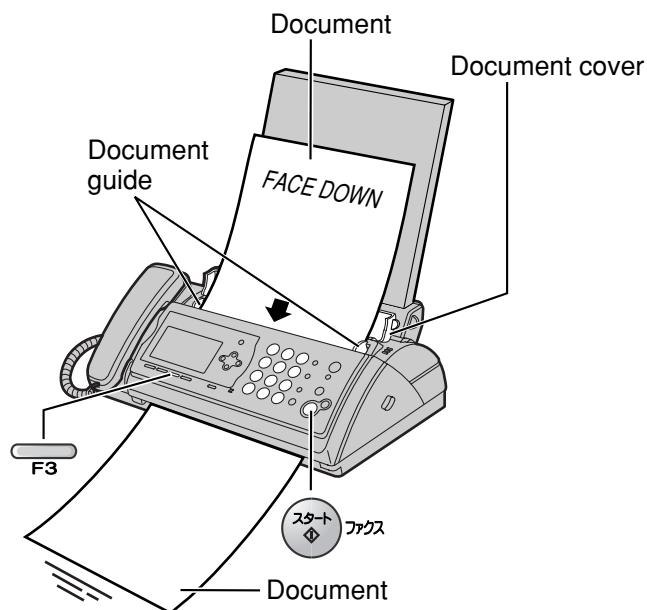

- 1 Open the document cover, and adjust the width of the document guides to the size of the document.
- 2 Insert the document (up to 5 pages) FACE DOWN until a single beep is heard.
- 3 If necessary, press (Resolution) repeatedly to select the desired setting (see below).
- 4 Dial the fax number.
- 5 Press (Fax).
 - The unit will start fax transmission.

Sending a fax using automatic dialing

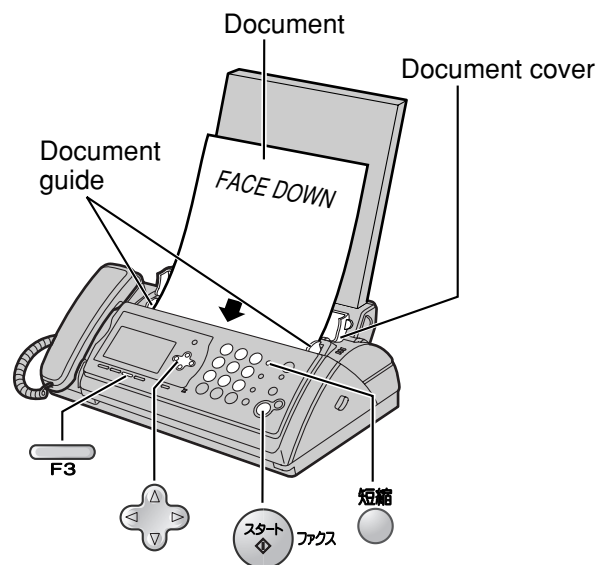

Using the speed dialer

- 1 Insert the document (up to 5 pages) FACE DOWN until a single beep is heard.
- 2 Press (Speed dialer), then press the memory station number (① to ⑨).
- 3 Press (Fax).
 - The unit will start fax transmission.

Using the phonebook

- 1 Insert the document (up to 5 pages) FACE DOWN until a single beep is heard.
- 2 Press (Phonebook).
- 3 Press (Search button) repeatedly until the desired name is displayed.
- 4 Press (Fax).
 - The unit will start fax transmission.

To select the resolution

Select the desired resolution according to the type of document, by pressing (Resolution).

画質 = ふう (Standard) for printed or typewritten originals with normal-sized characters.

画質 = 小さい (Fine) for originals with minute printing.

画質 = 写真 (Photo) for originals containing photographs.

Receiving faxes

Receiving a fax manually (AUTO ANSWER off)

Using the main unit:

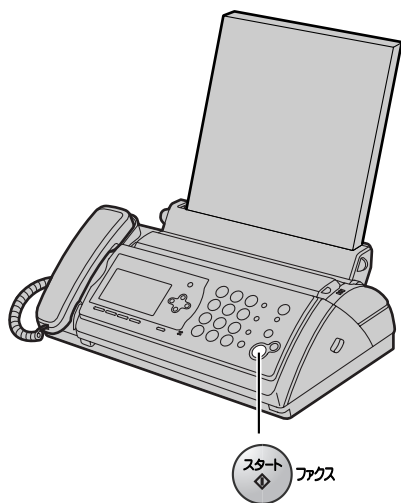

1 When you hear a ring, lift the handset to answer the call.

2 When:

- document reception is required,
- a fax calling tone (slow beep) is heard, or
- no sound is heard,

press  (Fax), then replace the handset.

- The unit will start fax reception.

Using the portable handset:

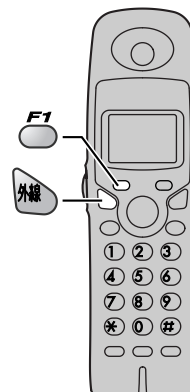

1 When you hear a ring, lift the portable handset from the charger to answer the call.

- If the portable handset is not set on the charger, press  (Talk).

2 When:

- document reception is required,
- a fax calling tone (slow beep) is heard, or
- no sound is heard,



press  (Fax reception) until a single beep is heard.

- The main unit will start fax reception.

Receiving faxes

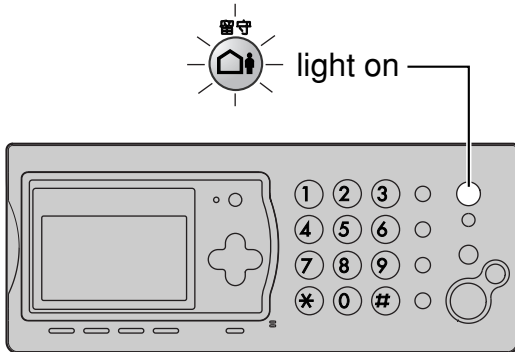
Receiving a fax automatically (AUTO ANSWER on)



1 If the  (Auto answer) light is off, turn it on by pressing .

2 When receiving a call, the unit will receive a fax document or record a voice message automatically depending on the caller's request.

Recording your own greeting message

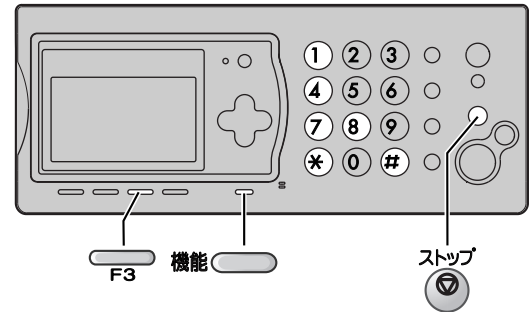

You can record your own greeting message. When receiving a call, it will be played to callers instead of the pre-recorded Japanese greeting message.

1 Press  (Function).

2 Press    .

自作応答録音

3 Press  (Set/Register).

4 Lift the handset.

5 Press  (Set/Register) and speak your greeting message, up to 16 seconds, to the handset.

6 Press  (Stop) and replace the handset.
• Your greeting message will be played back automatically.

Erasing your own greeting message

1 Press  (Function).

2 Press    .

自作応答消去

3 Press  (Set/Register).

4 Press .

• The pre-recorded Japanese greeting message will be played when you receive a call.

Operating the built-in answering device

Activating the answering device

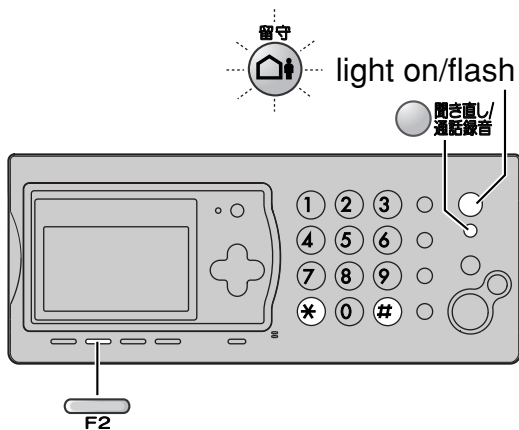

- 1 Turn the (Auto answer) light on by pressing .
- 2 When receiving a call, a greeting message will be played and the unit will record a voice message.
 - To record your own greeting message, see page 17.

Listening to recorded messages

When new messages are recorded, the (Auto answer) light will flash.

Press to listen to recorded messages.

After the messages are played back, the following will be displayed.

- To erase the messages, push . 再生した用件を消去
する=* しない=#
- To save the messages, push .

Listening to all of the recorded messages

Press (Replay/Record).

After the messages are played back, the following will be displayed.

- To erase the messages, push . 再生した用件を消去
する=* しない=#
- To save the messages, push .

Erasing a specific message

Press (Erase) while listening to the message you want to erase, then press .

Erasing all of the recorded messages

- 1 Press (Erase).

すべて消去しますか?
はい=* いいえ=#

- 2 Press .

Operating the answering device from a remote location

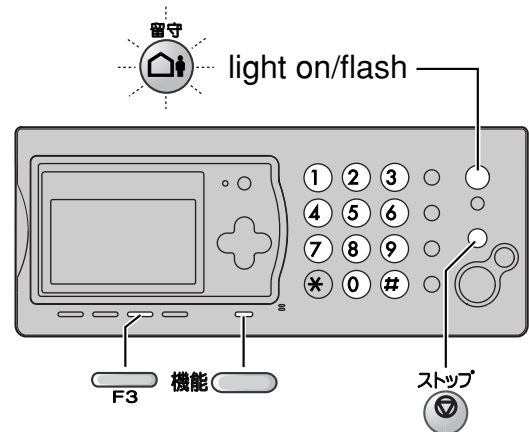

Preparation: Programming the remote operation ID

1. Press (Function).
2. Press .
3. Enter any 4-digit number (remote operation ID) except * or #.

Example : 暗証番号 = 1234
[4桁]

4. Press (Set/Register).
5. Press (Stop).

Operation: Listening to a recorded message from a remote location

Turn the (Auto answer) light on before you go out. Remote operations are available only from a touch tone telephone.

1. Call your unit.
2. Enter the remote operation ID during the greeting message.
3. Press or wait 4 seconds.
 - Only the new recorded messages will be played back.
 - To listen to all the recorded messages, press after the new messages have been played back.

Individual e-mail services

Using the e-mail services

Panasonic Communications Co., Ltd. (hereafter called "PCC") offers individual information services, such as e-mail.

Your fax machine with e-mail features will enable you to send an e-mail to another party's personal computer (PC) or another e-mail fax machine anywhere in the world through the Internet. Also, you will be able to receive an e-mail from them.

To access the Internet using your fax machine,

- you need a credit card (VISA, JCB or MASTER as of June 2003) and
- have to subscribe to individual information services offered by PCC beforehand.

The application fee including call charges will be charged to your Credit Card.

Important:

- If your fax machine is connected to a home telephone system or a private branch exchange (PBX) system, these services are not available.

Application fee and call charges

PCC information services	Registration fee	¥500
	Information Service fee (Call charge included)	¥20/minute (8 am-11 pm) ¥18.5/minute (11 pm-8 am)

- As of June 2003.
- Tax not included.

PCC information services

The following services are available with your fax machine. The information service fee including the call charge will be applied.

- E-mail reception and printing (page 21)
- Text e-mail sending (page 21)
- Fax e-mail sending (page 22)
- Storing e-mail addresses in the addressbook (free of charge) (page 23)
- Others

Note:

- PCC plans to add new information services and the information service fee is subject to change. PCC will announce them by e-mail to its customers.
- For the PC user to view your fax e-mail sent from your fax machine, the following PC software will be required.
 - E-mail software that can read the MIME format
 - TIFF viewer software

Individual e-mail services

Subscribing to PCC information services

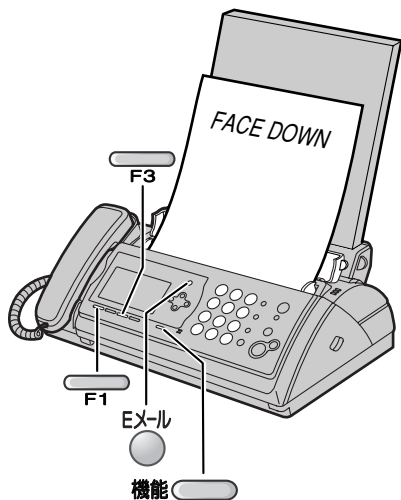

1 Fill in the included application form.

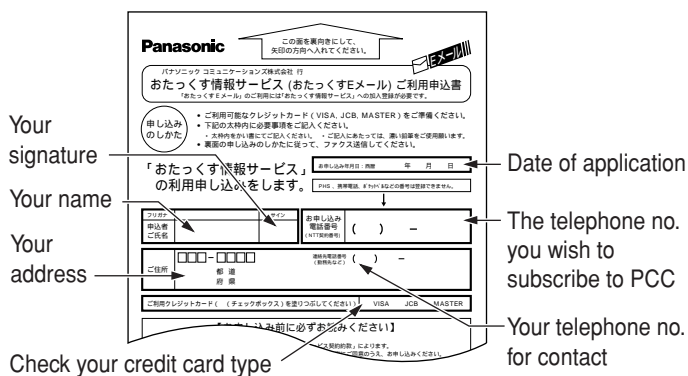

2 Press **機能** (Function), then press **EX-ル** (E-mail).

3 Press **決定/登録 F3** (Set/Register).

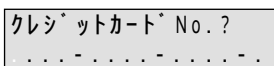

4 Enter your 16-digit credit card number.

- To correct a mistake, press **クリアー F1** (Clear).

5 Press **決定/登録 F3** (Set/Register).

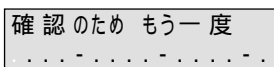

6 Enter your credit card number again, then press **決定/登録 F3** (Set/Register).

7 Enter the valid date of your credit card.

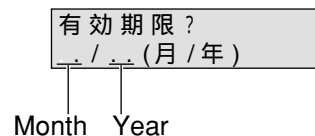

8 Press **決定/登録 F3** (Set/Register).

9 Insert the application form FACE DOWN.

10 Press **決定/登録 F3** (Set/Register).

- The unit will start fax transmission.

11 After approx. 5 minutes, the unit will ring, and a data communication will start automatically between your unit and PCC.

- If you answer this call, hang up and wait for a while until the communication is completed.

12 When the communication is completed, a user registration form will be printed.

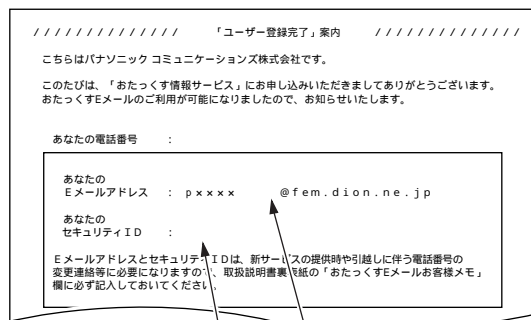

Your e-mail address
Your security ID code

- Please save the address and ID code for future reference.

13 Press **EX-ル** (E-mail).

14 Press **決定/登録 F3** (Set/Register).

- An information service guide will be printed.

Individual e-mail services

Receiving and printing an e-mail

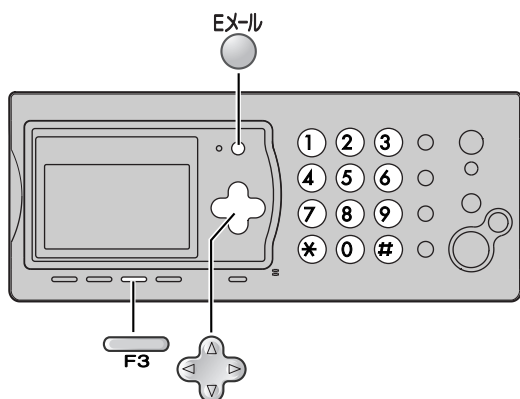

1 Press  (E-mail).

2 Press  (Set/Register).

- If there is an e-mail you have not viewed yet, the unit will print the received e-mail.
- If there is no e-mail, the following will be displayed.

未受信 Eメール 0件

The file formats recognized by your fax machine are:

- JPEG • ~. doc
 - TIFF • ~. xls
 - BMP • ~. ppt
 - TXT • ~. pdf
- (as of June 2003)

Sending a text e-mail from the main unit



1 Press  (E-mail).

2 Press  (Search button) repeatedly until the following is displayed.

文字 Eメール送信

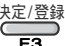
3 Press  (Set/Register).

4 Enter the desired e-mail address (see the table on page 9 for instructions), then press  (Set/Register).

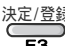
- You can enter the address of the last e-mail you sent by pressing  (Redial).
- You can select the desired address using the addressbook.
 1. Press  (Addressbook).
 2. Press  (Search button) repeatedly until the desired name is displayed.
 3. Press  (Set/Register).To store an address, see page 23.

5 Press  (Set/Register).

6 Enter the title of your e-mail, up to 32 characters (see the table on page 9 for instructions).

- You can enter the title of the last e-mail you sent by pressing  (Redial).

7 Press  (Set/Register).

8 Enter your e-mail message, up to 200 characters (see the table on page 9 for instructions).

- You can enter the message of the last e-mail you sent by pressing  (Redial).

9 Press  (Set/Register).

Individual e-mail services

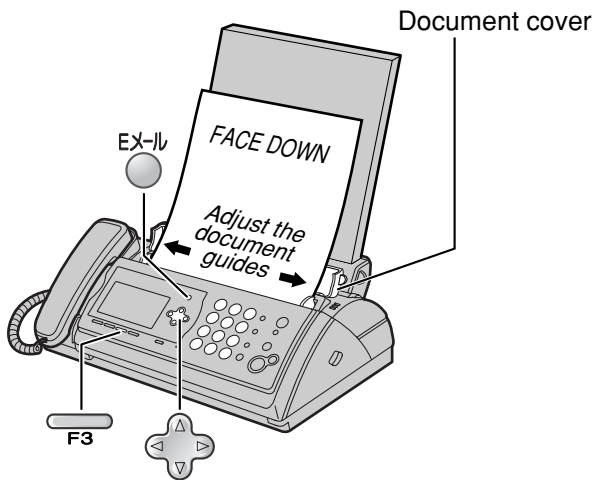

Sending a fax e-mail





1 Open the document cover, and adjust the width of the document guides to the size of the document.

2 Insert the document (up to 5 pages) FACE DOWN until a single beep is heard.

3 If necessary, press  (Resolution) repeatedly to select the desired setting (see page 15).

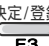
4 Press  (E-mail), then press  (Set/Register).

5 Enter the desired e-mail address (see the table on page 9 for instructions), then press  (Set/Register).

- You can enter the address of the last e-mail you sent by pressing  (Redial).

- You can select the desired address using the addressbook.

1. Press  (Addressbook).

2. Press  (Search button) repeatedly until the desired name is displayed.

3. Press  (Set/Register).

To store an address, see page 23.

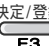
6 Press  (Set/Register).

7 Enter the title of your fax e-mail, up to 32 characters (see the table on page 9 for instructions).

- You can enter the title of the last e-mail you sent by pressing  (Redial).

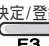
8 Press  (Set/Register).

Individual e-mail services

Storing names and e-mail addresses in the addressbook

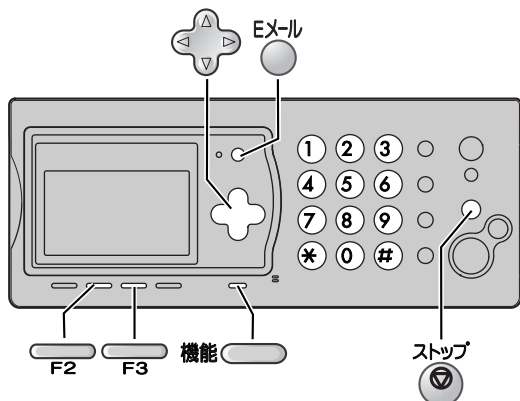

- 1 Press **機能** (Function), then press **Eメール** (E-mail).
- 2 Press **◀▶** (Search button) repeatedly until the following is displayed.

アト*レス帳
- 3 Press **決定/登録 F3** (Set/Register) twice.
- 4 Enter the name, up to 20 characters (see the table on page 9 for instructions).

アト*レス帳
- 5 Press **決定/登録 F3** (Set/Register) twice.
- 6 Enter the e-mail address, up to 60 characters (see the table on page 9 for instructions).
- 7 Press **決定/登録 F3** (Set/Register).
 - To program other items, repeat steps 4 to 7.
- 8 Press **ストップ** (Stop) to exit the program.

Editing a stored name or e-mail address in the addressbook

- 1 Press **機能** (Function), then press **Eメール** (E-mail).
- 2 Press **◀▶** (Search button) repeatedly until the following is displayed.

アト*レス帳
- 3 Press **決定/登録 F3** (Set/Register).
- 4 Press **◀▶** (Search button) repeatedly until the desired name is displayed.
- 5 Press **修正 F2** (Edit).
- 6 Edit the name (see the table on page 9 for instructions).
 - If you do not need to edit the name, skip to step 7.
- 7 Press **決定/登録 F3** (Set/Register).
- 8 Edit the kana.
 - If you do not need to edit the kana, skip to step 9.
- 9 Press **決定/登録 F3** (Set/Register).
- 10 Edit the e-mail address (see the table on page 9 for instructions).
 - If you do not need to edit the e-mail address, skip to step 11.
- 11 Press **決定/登録 F3** (Set/Register).
- 12 Press **ストップ** (Stop) to exit the program.

Specifications

KX-PW601DL KX-PW601DW	Main unit	Portable handset	Battery charger
Power supply	AC 100 V (50 Hz/60 Hz)	Ni-MH battery (Part no. KX-FAN50) DC 3.6 V, 600 mAh	AC adaptor (Part no. PFAP1009) AC 100 V (50 Hz/60 Hz) DC 7.5 V, 100 mA
Frequency	2.4 GHz		
Power consumption	Transmission: Approx. 16 W Reception: Approx. 22 W Copy: Approx. 20 W Stand by: Approx. 1.2 W (When the F-net service is not in use.) Maximum(*1): Approx. 130 W		<ul style="list-style-type: none"> • Charging: Approx. 1.5 W • Stand by: Approx. 0.6 W
Dimensions (H x W x D)	Approx. 140 X 331 X 237 mm (without projections) Approx. 365 X 331 X 268 mm (recording paper tray installed, without projections)	Approx. 161 X 47 X 39 mm	Approx. 64 X 80 X 90 mm
Mass (Weight)	Approx. 3.4 kg (10 m ink film installed)	Approx. 140 g (battery installed)	Approx. 80 g
Operating environment	5 °C – 35 °C, 45 % – 85 % RH (Relative Humidity)		

KX-PW601DL KX-PW601DW	Main unit
Applicable line	Public Switched Telephone Network (Tone/Pulse), F-Net, NCC Lines
DC resistance	320 Ω (*2)
Compatibility	G3 compatible
Document size	A4-A5 (Max.216 mm in width, Max. 600 mm in length)
Effective scanning size	208 mm (A4)
Effective printing size	202 mm (A4 size plain paper)
Transmission time	Approx. 15 s/page (Original mode) (*3)
Modem speed	9,600 / 7,200 / 4,800 / 2,400 bps; Automatic fallback
Halftone level	64-level
Scanning density	Horizontal : 8 pels/mm Vertical : 7.7 lines/mm (Fine/Photo), 3.85 lines/mm (Standard)
Scanner type	Contact image sensor
Printer type	Thermal transfer printing on plain paper
Data compression system	Modified Huffman (MH), Original mode
Recording paper size	A4: 210 mm x 297 mm (Plain paper)
Answering device	Greeting message: Digital recording system (up to 16 sec) Pre-recording greeting message ICM Recording: Digital recording system (Approx. 18 min. in total) (*4)
Memory capacity	Max. Approx. 46 pages (Only receiving fax etc.) (*5) Max. Approx. 18 min. (Only Recording message) (*4)

*1 When copying a 100% black document.

*2 If you can not make a call due to DC resistance, consult your dealer.

*3 Transmission speed is based on an A4-size document of 700 characters sent in standard resolution at 9,600 bps. The actual transmission speed depends upon the contents of the page, resolution, telephone line conditions and capability of the other party's machine.

*4 If there is a silent pause, the total recording time will be longer.

*5 The memory capacity is based on an A4-size document of 700 characters.